

RoHS Compliance

# LP-10F LP-10FB

## FEATURES

- 10mm stroke
- Low friction & long life
- 2 types Input shaft Interface.
- Available with mounting 4 surface

## Electrical Specifications

<b>Electrical Stroke</b>	10mm ± 0.5mm
<b>Total Resistance</b>	1k
<b>Total Resistance Tolerance</b>	± 20%
<b>Independent Linearity</b>	± 1%
<b>Power Rating</b>	0.3W/50
<b>Output Smoothness</b>	0.1% MAX.
<b>Insulation Resistance</b>	100M MIN. DC 500V
<b>Dielectric Strength</b>	AC500V 1 Minute
<b>TC of Resistance</b>	± 1000ppm /

## Mechanical Specifications

<b>Mechanical Stroke</b>	12mm ± 1mm
<b>Friction</b>	LP-10F : 0.3N MAX. LP-10FB : 3N MAX.(Spring Strength)
<b>Weight</b>	Approx. 60g

## Environmental Specifications

<b>Operating Temperature</b>	40 ~ 100
<b>Vibration</b>	100m / s <sup>2</sup> 500Hz 3 axis 2hours each
<b>Shock</b>	500m / s <sup>2</sup> 11ms 6 axis 3times
<b>Life Cycle</b>	5M Cycles MIN.

## DIMENSION (mm)

• LP-10F

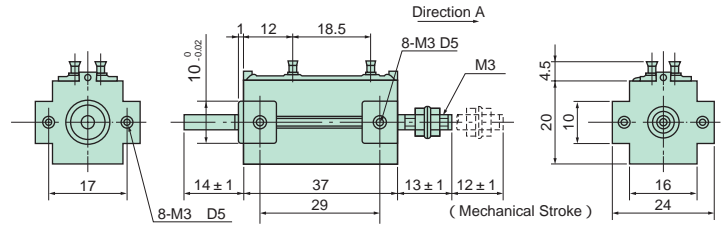

• LP-10FB( With Back Spring )

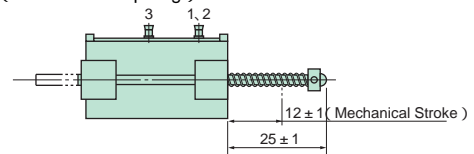

Other dimensions are same as LP-10F

## MOUNTING

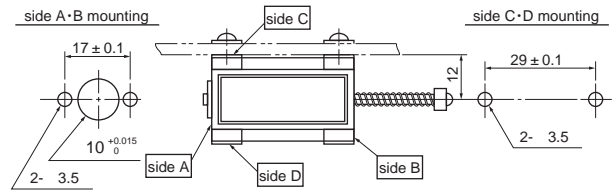

MOUNTING HARDWARE  
2-M3 Nuts, 2-Lock Washers

## SCHEMATIC

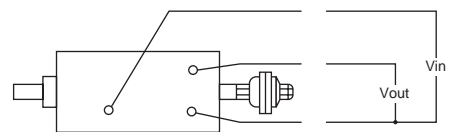

1,2,3 indicate terminal No.

## OUTPUT CHARACTERISTICS

