

RoHS Compliance

CP-2FWP-10S

FEATURES

- Dustproof & Dripproof type (Except terminal area)
- Shaft D-cut
- Housing: aluminum die-casting

DIMENSION (mm)

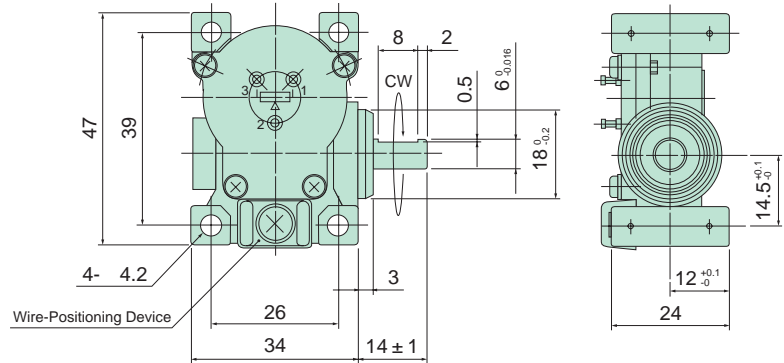

Electrical Specifications

Electrical Angle	3400 $^{+20}_{-30}$ °
Total Resistance	1、2、5k
Total Resistance Tolerance	± 20%
Independent Linearity	± 1.5% (Including Backlash)
Power Rating	0.5W / 50
Output Smoothness	0.1% MAX.
Insulation Resistance	100M MIN. DC 1000V
Dielectric Strength	AC 1000V 1 Minute
TC of Resistance	± 400ppm /

Mechanical Specifications

Gear Ratio	10 : 1
Torque	25mN·mMAX.
Repeatability	0.5% MAX. (Including Backlash)
Weight	Approx. 55g
Radial Load	5N MAX.
Thrust Load	3N MAX.

Environmental Specifications

Operating Temperature	40 ~ 80
IP Level	IP65

MOUNTING

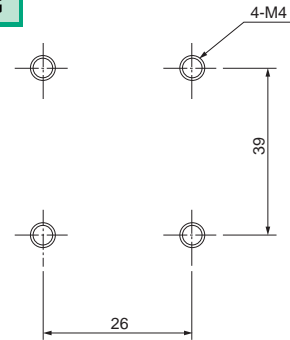

SCHEMATIC

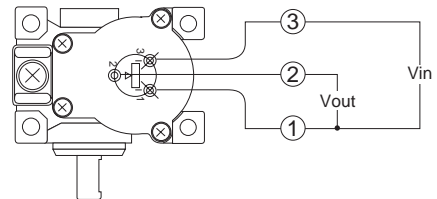

1,2,3 indicate terminal No.



• We recommend potting treatment at the terminal outlet for water-proof after connected leadwires.

OUTPUT CHARACTERISTICS

